

Clip A

16g ASTM A653 SS Grade 33 G60
Bare Metal Thickness: $t = 0.054$ "

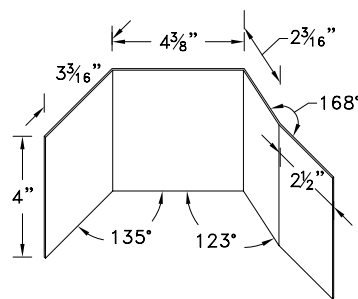

Clip B

16g ASTM A653 SS Grade 33 G60
Bare Metal Thickness: $t = 0.054$ "

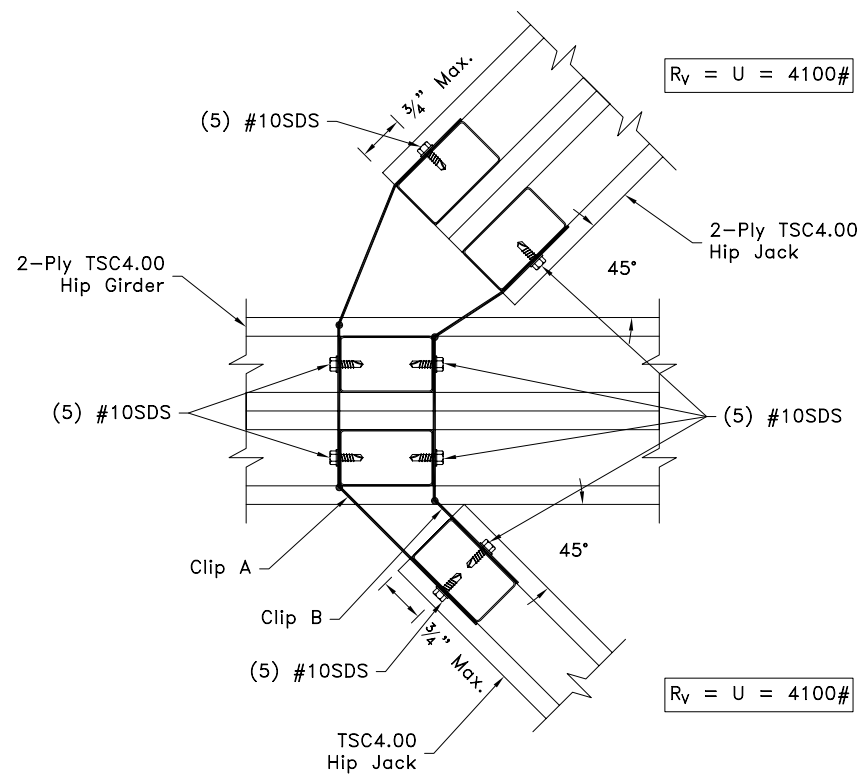

Plan View

General Notes:

1. SDS = self-drilling tapping screw
2. #10SDS edge distance, end distances and spacing are 9/16" minimum.
3. Truss must be analyzed with concentrated loads directly in line with correctly placed girder vertical webs.
4. For clips connecting to a Z-Web vertical refer to TS068 for connection area.
5. R_v refers to vertical reaction, and U refers to uplift.
6. Cold-Formed Steel Calculations are per the 2010 addendum to the "AISI 2007 North American Specification for the Design of Cold-Formed Steel Structural Members." (S100-07/S2-10)

TrusSteel®
An ITW Company

www.TrusSteel.com

Florida: 1950 Marley Drive / Haines City, FL 33844 / (800) 755-6001
Missouri: 13389 Lakefront Drive / Earth City, MO 63045 / (800) 326-4102
California: 8351 Rovana Circle / Sacramento, CA 95828 / (800) 877-3678

2 Sided 45° 2-Ply Hip Girder Truss-To-Truss Connection

ITW Building Components Group, Inc. shall not be responsible for any performance failure in a connection due to a deviation from this detail. Any variation from this detail shall be approved in advance by ITW Building Components Group, Inc.

Custom Detail:

TS-CD-TT-4509-003

Date:

05/18/11

Custom Detail Category:

Truss-to-Truss Connection